

KGYR Phoenix Goodyear Airport
ATCA Goodyear, AZ
GLENDALE POWER PLANT DEP
VFR DP PROC MAR 07
ATCA Goodyear, AZ
GLENDALE POWER PLANT DEP
VFR DP PROC

GYR ATIS 118.35	GYR GND 121.70	GYR TWR 120.10	GEU ATIS 119.42	GEU TWR 121.0	PHX DEP 120.7
---------------------------	--------------------------	--------------------------	---------------------------	-------------------------	-------------------------

NOTES: 1. NOT AUTHORIZED FOR SOLO AIRCRAFT. 2. ALL aircraft should call GCU tower over Tolleson for transition. 3. Aircraft arriving GEU should expect right base RWY 01 or left downwind RWY 19. 4. ALL aircraft should pass 1 NM right of the I-10/101 interchange and 1 NM right of the Glendale Power Plant. 5. Monitor the north training area frequency 122.75 passing the Glendale Power Plant. 6. All headings are approximate, wind correction should be applied for desired ground track.

MSA PXR VOR

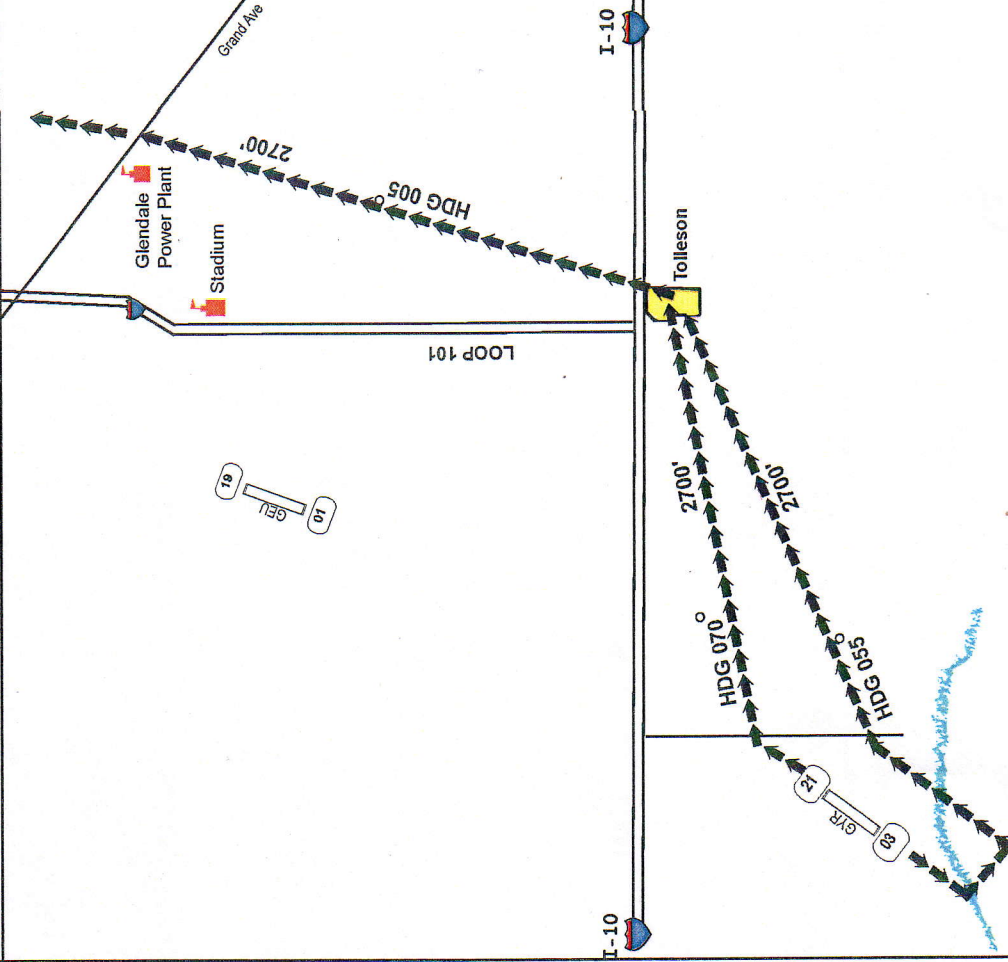
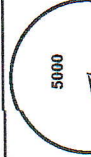

RWY 21: Climb straight out 2500' MSL or the Gila River whichever comes first, continue climbing and MAINTAIN 2700' MSL on a left downwind departure. Abeam the GYR tower fly heading 055 until abeam the I-10/101 interchange. Thence
RWY 3: Climb straight out 2000' MSL or Litchfield Rd, whichever comes first, turn heading 070 and continue climb until abeam the I-10/101 interchange, MAINTAIN 2700' MSL. Thence
Departure: Fly heading 005, MAINTAIN 2700' MSL until abeam the Glendale Power Plant. Passing the Power Plant climb on course.

KGYR Phoenix Goodyear Airport
ATCA Goodyear, AZ
TWIN LAKES DEP
VFR DP PROC MAR 07
ATCA Goodyear, AZ
TWIN LAKES DEP
VFR DP PROC

ATIS 118.35	GYR OPS 131.47	GYR GND 121.70	GYR TWR 120.10	AIR - AIR 128.92	1A20 CTAF 130.47
-----------------------	--------------------------	--------------------------	--------------------------	----------------------------	----------------------------

NOTES: 1. ALL aircraft avoid overflying the housing community surrounding Twin Lakes. 2. Monitor the south training area frequency 128.92 passing Liberty Bridge. 3. All headings are approximate, wind correction should be applied for desired ground track.

MSA BXX VOR

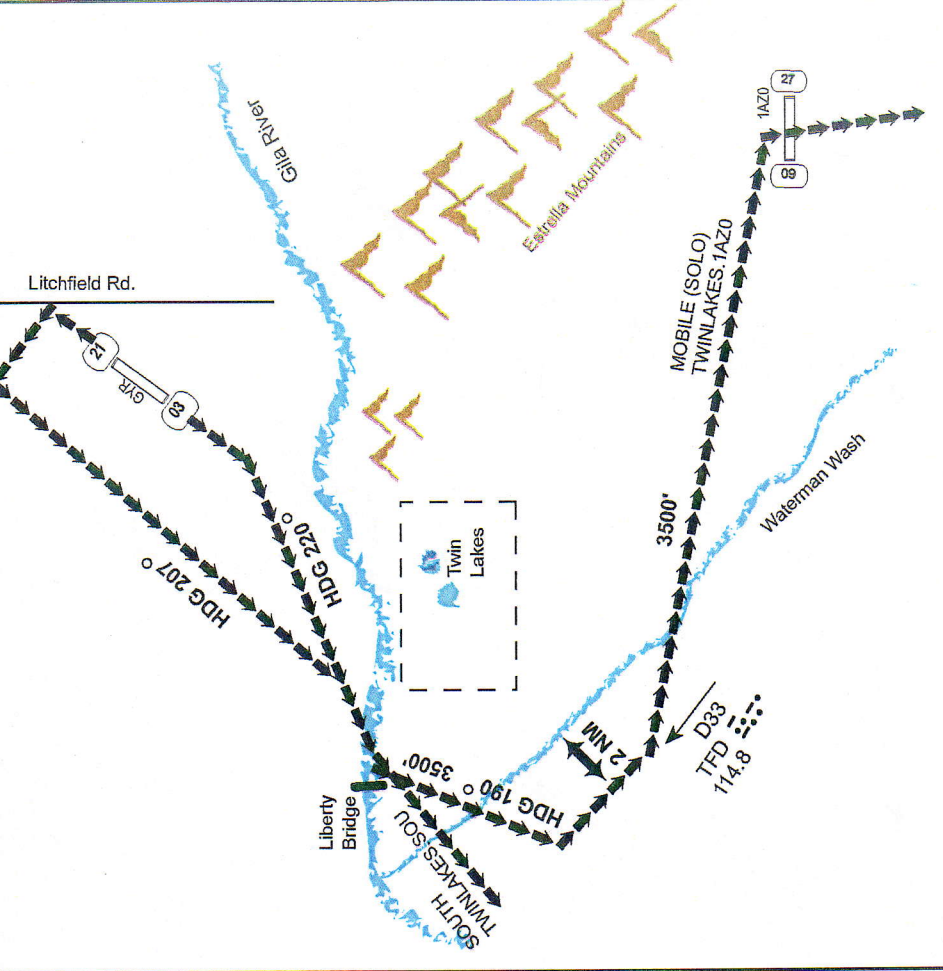

RWY 21: Fly runway heading until 500' AGL, then turn heading 220, climb unrestricted but not above 5000' MSL. (ALL SOLOS MAINTAIN 3500' MSL) Thence
RWY 03: Fly a left downwind departure, climb unrestricted but not above 5000' MSL. (ALL SOLOS MAINTAIN 3500' MSL) Thence
South Transition: Abeam Twin Lakes on course is approved
Mobile Transition (SOLO): Continue HDG 220 until over Liberty Bridge MAINTAIN 3500. Fly hdg 190 until 2 NM southwest of Waterman Wash. Parallel Waterman Wash until 10 NM northwest of Mobile airport turn direct Mobile for midfield crossing. Passing overhead climb on course. (ALL Aircraft announce intentions to Mobile traffic 10 NM northwest)

Goodyear, AZ
ATCA
 Phoenix Goodyear Airport
GLENDALE POWER PLANT ARRIVAL
 VFR ARRIVAL PROC
 AUG 06

PHX APP 120.7	GEU ATIS 119.42	GEU TWR 121.0	GYR ATIS 118.35	GYR TWR 120.10	GYR GND 121.70
------------------	--------------------	------------------	--------------------	-------------------	-------------------

NOTES: 1. NOT AUTHORIZED FOR SOLO AIRCRAFT. 2. Pass 1 NM right of the Glendale Power Plant and I-10/Loop 101 Interchange. 3. ALL Aircraft contact the GEU Tower prior to the Glendale Power Plant for Class D transition. 4. Lower Buckeye Road can be identified by the southern most row of trees and a large round-about. 5. All headings are approximate, wind correction should be applied for desired ground track. 6. All aircraft landing runway 21 shall comply with the GYR Noise Abatement procedures.

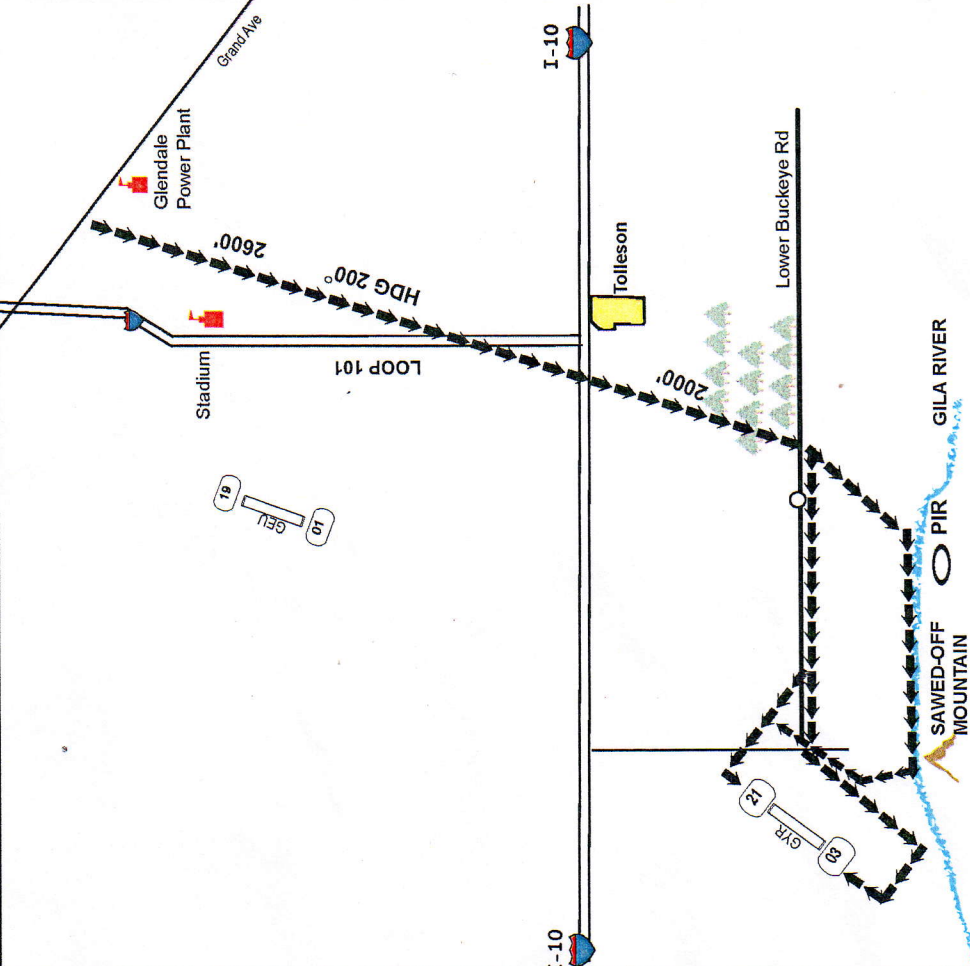

Arrival: Abeam Glendale Power Plant fly heading 200, MAINTAIN 2600' MSL until abeam I-10/Loop 101 interchange. Crossing the I-10 descend and MAINTAIN 2000' MSL direct to Lower Buckeye Rd. Proceed as directed by the GYR tower.
RWY 21: Expect left base entry. Fly Parallel Lower Buckeye Rd. until approximately 2 NM left base. For left downwind entry proceed direct PIR, direct Sawed-Off Mountain then turn direct the GYR Tower for the 45 entry.
RWY 3: Expect right downwind entry. Fly parallel Lower Buckeye Rd. to enter right downwind.

Goodyear, AZ
ATCA
 Phoenix Goodyear Airport
GAP ARRIVAL
 VFR ARRIVAL PROC
 AUG 06

1AZ0 CTAF 130.47	ATIS 118.35	AIR - AIR 128.92	GYR TWR 120.10	GYR GND 121.70	GYR OPS 131.47
---------------------	----------------	---------------------	-------------------	-------------------	-------------------

NOTES: 1. The South Transition is only authorized for Dual flights. 2. All aircraft landing runway 21 shall comply with the GYR Noise Abatement procedures. 3. All headings are approximate, wind correction should be applied for desired ground track.

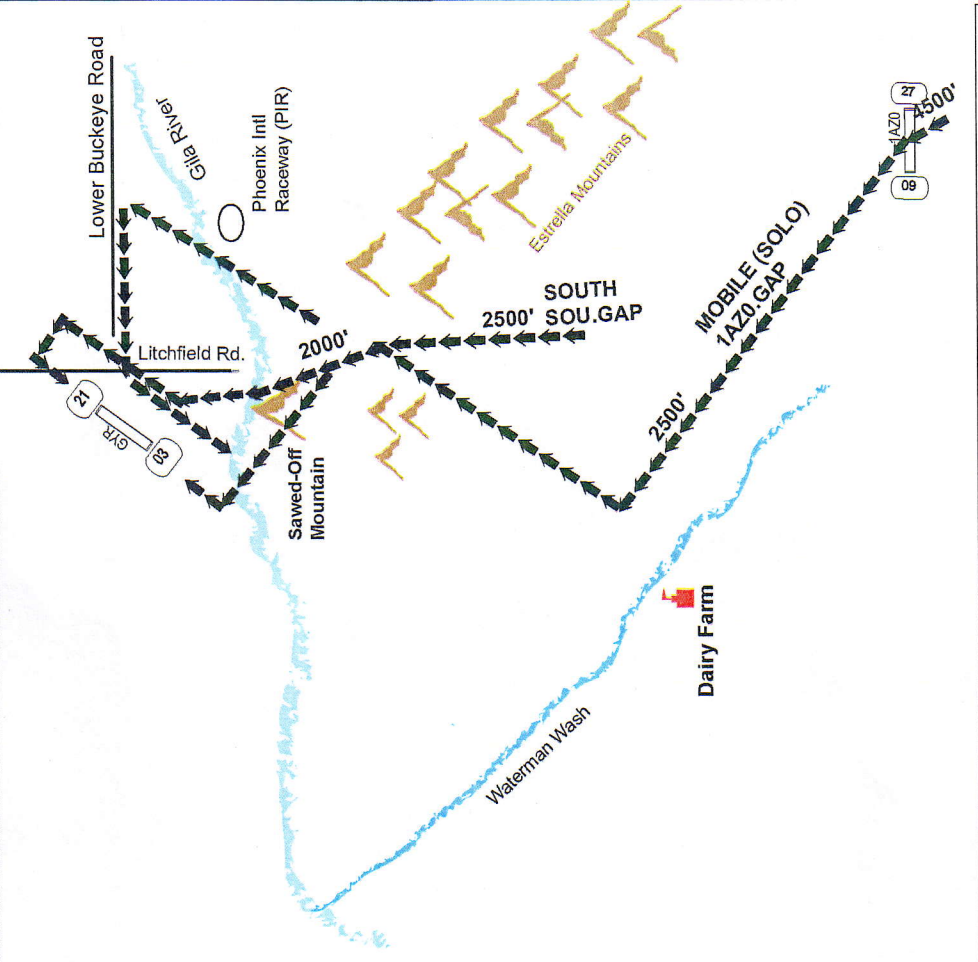

South Transition: ALL Aircraft should arrive from south of the Gap at 2500' MSL. Thence Mobile Transition (SOLO); ALL Aircraft should MAINTAIN 4500' MSL to cross 1AZ0 midfield. Descend and MAINTAIN 2500' MSL via a course to parallel Waterman Wash 2 NM east. Abeam the Dairy Farm turn direct the Gap. Thence
Arrival: From the Gap, Descend and MAINTAIN 2000' MSL direct Sawed-Off Mountain, enter the GYR traffic pattern as directed by the tower.
RWY 21: Expect left downwind entry Proceed direct the GYR Tower and enter left downwind.
RWY 3: Expect right base entry. Prior to Sawed-Off Mountain turn right Base. For right-downwind entry proceed NE from the Gap to Lower buckeye Road. Parallel west bound into the right downwind for RWY 3.

Goodyear, AZ
ATCA
 Phoenix Goodyear Airport
 Goodyear
 Lufthansa
 MAR 07

AIR-AIR	122.85	ATIS	118.35	GYR TWR	120.10	GYR GND	121.70	GYR OPS	131.47
---------	--------	------	--------	---------	--------	---------	--------	---------	--------

NOTES: 1. Arrive 1 NM to the right of Gila Crossing. 2. All aircraft landing RWY 21 should comply with the GYR noise abatement procedures. 3. Lower Buckeye Rd. can be identified by the southern most row of 3 rows of trees, and there is a roundabout approximately where a 320 course intercepts the road. 4. All headings are approximate, wind correction should be applied for desired ground track.



MSA PXR VOR

Goodyear, AZ
ATCA
 Phoenix Goodyear Airport
 Goodyear
 Lufthansa
 MAR 07

LUKE AP/DP	125.45	BXK CTAF	122.80	ATIS	118.35	GYR TWR	120.10	GYR GND	121.70	GYR OPS	131.47
------------	--------	----------	--------	------	--------	---------	--------	---------	--------	---------	--------

NOTES: 1. All transitions should arrive 1 NM south of Luke Aux 6. 2. Initial calls to the GYR Tower should be made abeam Luke Aux 6. 3. In all cases avoid the Palo Verde Nuclear Power Plant by no less than 3 NM. 4. All headings are approximate, wind correction should be applied for desired ground track.



MSA BXK VOR

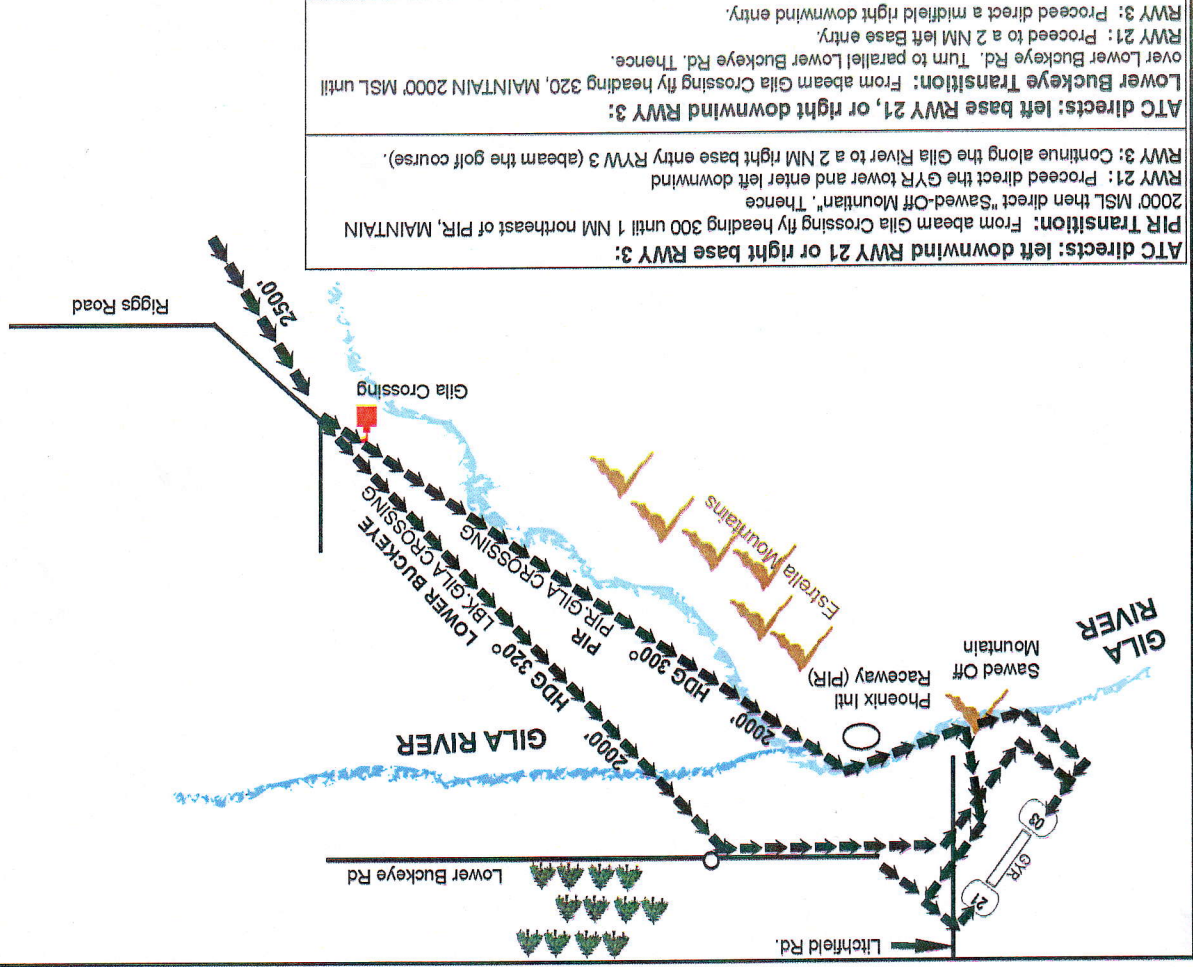

ATC directs: left downwind RWY 21 or right base RWY 3: Continue along the Gila River to a 2 NM right base entry RYV 3 (abeam the golf course).
PIR Transition: From abeam Gila Crossing fly heading 300 until 1 NM northeast of PIR, MAINTAIN 2000' MSL then direct "Sawed-Off Mountain". Thence
 2000' MSL then direct the GYR tower and enter left downwind
Lower Buckeye Transition: From abeam Gila Crossing fly heading 320, MAINTAIN 2000' MSL until over Lower Buckeye Rd. Turn to parallel Lower Buckeye Rd. Thence.
RWY 21: Proceed to a 2 NM left base entry.
RWY 3: Proceed direct a midfield right downwind entry.

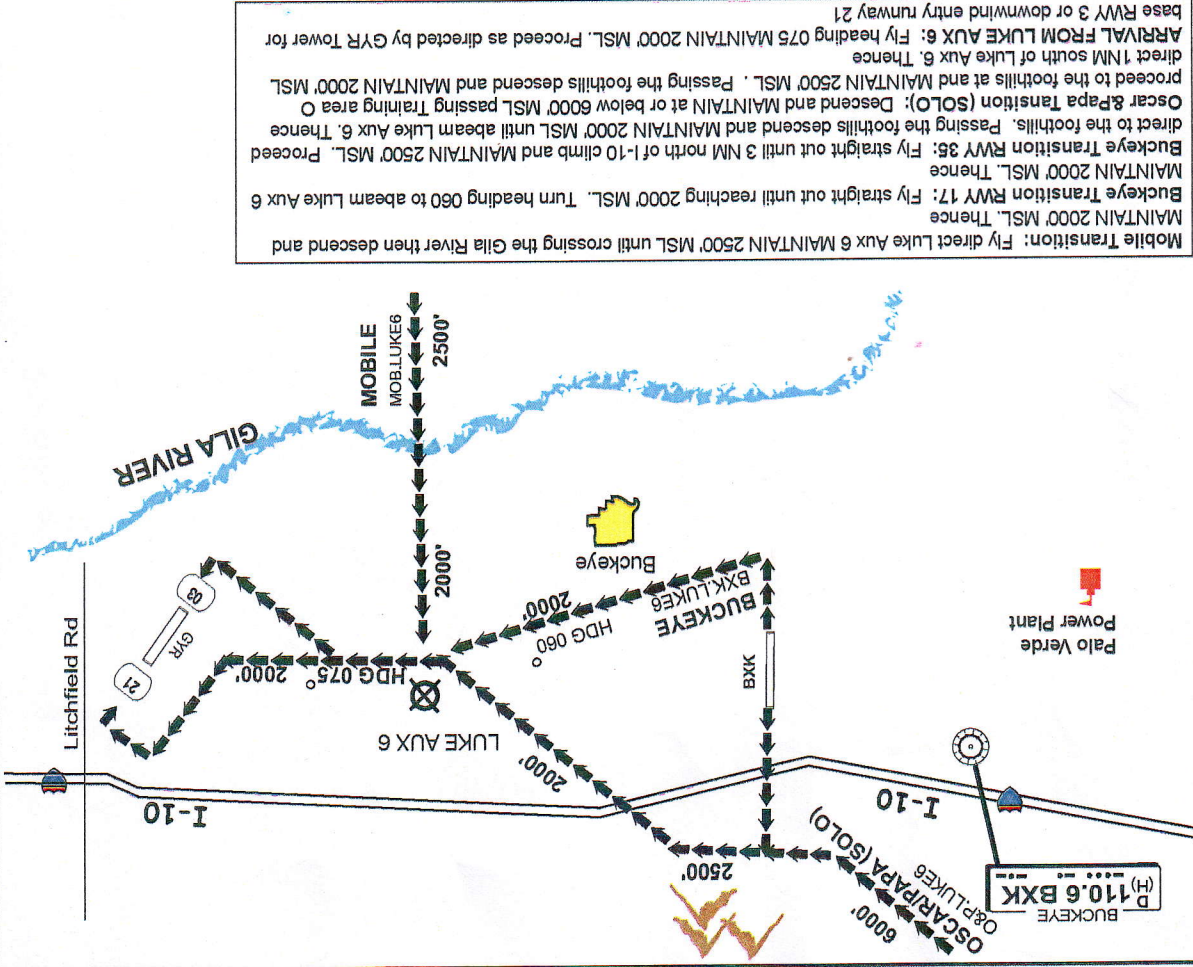

Mobile Transition: Fly direct Luke Aux 6 MAINTAIN 2500' MSL until crossing the Gila River then descend and MAINTAIN 2000' MSL. Thence
Buckeye Transition RWY 17: Fly straight out until reaching 2000' MSL. Turn heading 060 to abeam Luke Aux 6 MAINTAIN 2000' MSL. Thence
Buckeye Transition RWY 35: Fly straight out until 3 NM north of I-10 climb and MAINTAIN 2500' MSL. Proceed direct to the foothills. Passing the foothills descend and MAINTAIN 2000' MSL until abeam Luke Aux 6. Thence
Oscar & Papa Transition (SOLO): Descend and MAINTAIN at or below 6000' MSL passing Training area O proceed to the foothills at and MAINTAIN 2500' MSL. Passing the foothills descend and MAINTAIN 2000' MSL direct 1 NM south of Luke Aux 6. Thence
ARRIVAL FROM LUKE AUX 6: Fly heading 075 MAINTAIN 2000' MSL. Proceed as directed by GYR Tower for base RWY 3 or downwind entry runway 21